

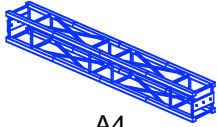

A3



A4



R1



LPTP



LIT



BDLT

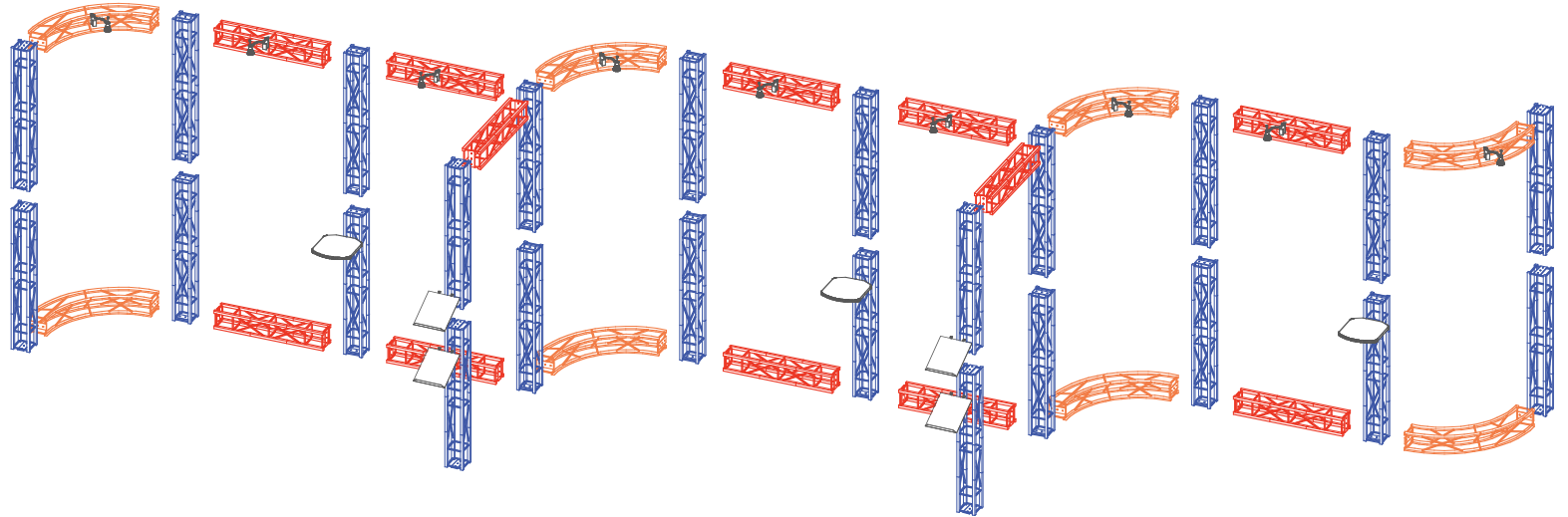

Click it. Buy it. Displayit.com

# EZ6 Truss - 10'x30' Napa Setup Drawing

www.displayit.com 800.207.0311 770.931.8095 130 Satellite Blve NE STE E Suwanee, GA 30024



## A. To attach top spans

Hang the bracket from the top wire with the bottom tabs behind the second wire.

Position the horizontal such that the bracket stud goes through the center hole.

Install and tighten the wing-nut making sure the alignment wire goes between the horizontal tubes.

The horizontal truss should be flush with the top of the upright.

## B. To attach bottom spans

Hang the bracket from the higher of the 2 wires with the bottom tabs behind the lower wire.

Position the horizontal such that the bracket stud goes through the center hole.

Install and tighten the wing-nut making sure the alignment wire goes between the horizontal tubes.

The horizontal truss should be 1/2" off the ground.

