



Watch the setup video:
<http://youtu.be/d8igQVwKAAAY>

Assembly



1. Make sure loop velcro on graphic "endcaps" flap is not attached to hook velcro on frame.

Grasp back of frame and expand slowly, pulling frame upright. Adjustable feet indicate the bottom of the frame.

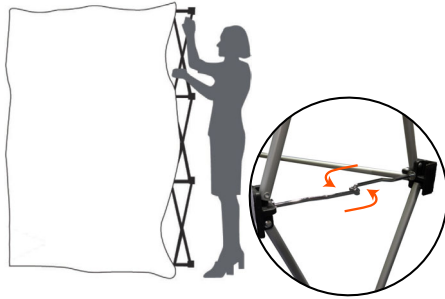

2. Lock all frame hooks.

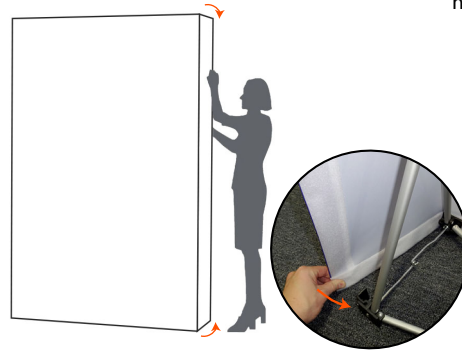

3. Wrap fabric graphic "endcap" flap around side of frame and connect to velcro on frame.

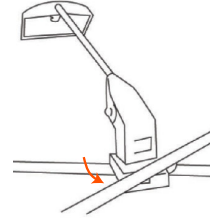

4. Optional LED lights attach to the frame as seen above.



Closing the Frame

1. Unhook side endcap velcro from frame (Only the vertical strips on the endcap flaps, leave the rest of the graphic attached to frame).
2. Unlock ALL HOOKS. Failure to disengage all hooks will cause frame damage when collapsing frame.
3. Slowly collapse frame. If you feel resistance, double-check to make sure all hooks are unlocked.

DO NOT FORCE FRAME CLOSED.

Attaching Graphic to the Frame

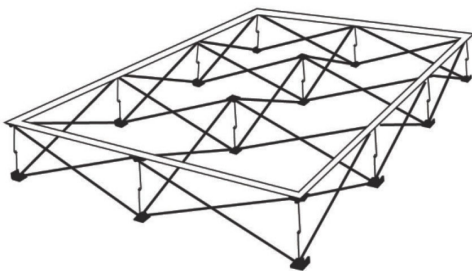

Expand frame outward on its back. Lock all hooks.

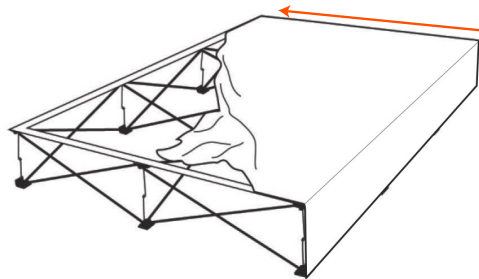

Starting on one top corner, secure the graphic onto the frame by attaching the velcroed piece of the graphic onto the frame's velcro strip. Repeat on bottom edge, working the same direction.
 Note: Adjustable feet indicate bottom of frame.

