

# Curved Helium Display Assembly Instructions

Note: Assembly is the same for all sizes of curved Helium displays



1. Assemble bungeed poles.



2. Connect large bungied poles to corners, matching up stickers.



3. Pull the pillowcased graphic over the frame. Do not zip until after center pole is installed.

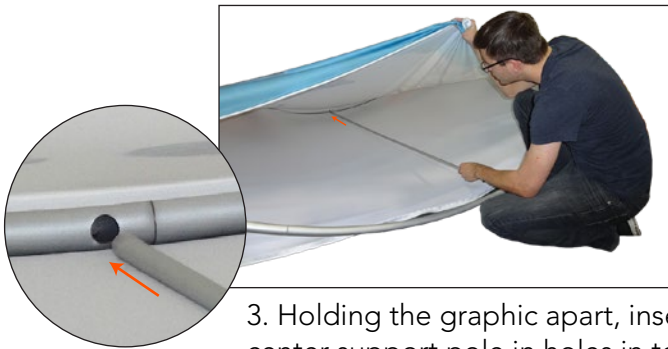

3. Holding the graphic apart, insert center support pole in holes in top and bottom curved poles.



5. Zip up the bottom of the graphic.



6. Attach optional light clamps to the top bar in desired locations.

Tip: It is easier to do this before standing the display up.

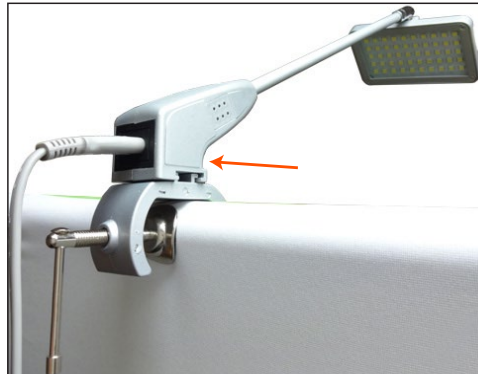

7. Connect LED lights to the clamp.



8. Stand the display up and move into desired position.



9. Straighten the frame. Have two people hold the sides of the frame, then gently twist until the frame is straight.

Need Help?



How To Straighten Your Frame!